

NOTES:

1. ALL DIMENSIONS ARE SHOWN IN MILLIMETRES (mm) UNLESS NOTED OTHERWISE.
2. NO DIMENSIONS ARE TO BE SCALED FROM THIS DRAWING.
3. DRAWING FOR PLANNING APPLICATION TO BANNAU BRYCHEINIOG (BRECON BEACONS) NATIONAL PARK AUTHORITY ONLY. NOT TO BE USED FOR ANY OTHER PURPOSE.
4. THIS DRAWING SHOULD BE READ IN CONJUNCTION WITH INFORMATION PROVIDED AS PART OF THE PLANNING APPLICATION FOR THE WORKS.
5. REFER TO THE FOLLOWING DRAWINGS FOR MORE INFORMATION:
 B17545-123532-12-ZZ-DR-CA-PN1201 - PROPOSED WORKS SITE LAYOUT
 B17545-123532-12-ZZ-DR-CA-PN1202 - PROPOSED CROSS SITE ELEVATIONS
 B17545-123532-12-XX-DR-CA-PN1203 - ENABLING WORKS LAYOUT PLAN
6. SITE LOCATED AT CEFN DRYSCOED WTW WITH GRID REFERENCE: SN 908094.

KEY:

- DCWW LAND BOUNDARY
- PLANNING APPLICATION BOUNDARY AREA = 20710 SQ.MT.
- EXISTING PUBLIC RIGHT OF WAY (PROW)

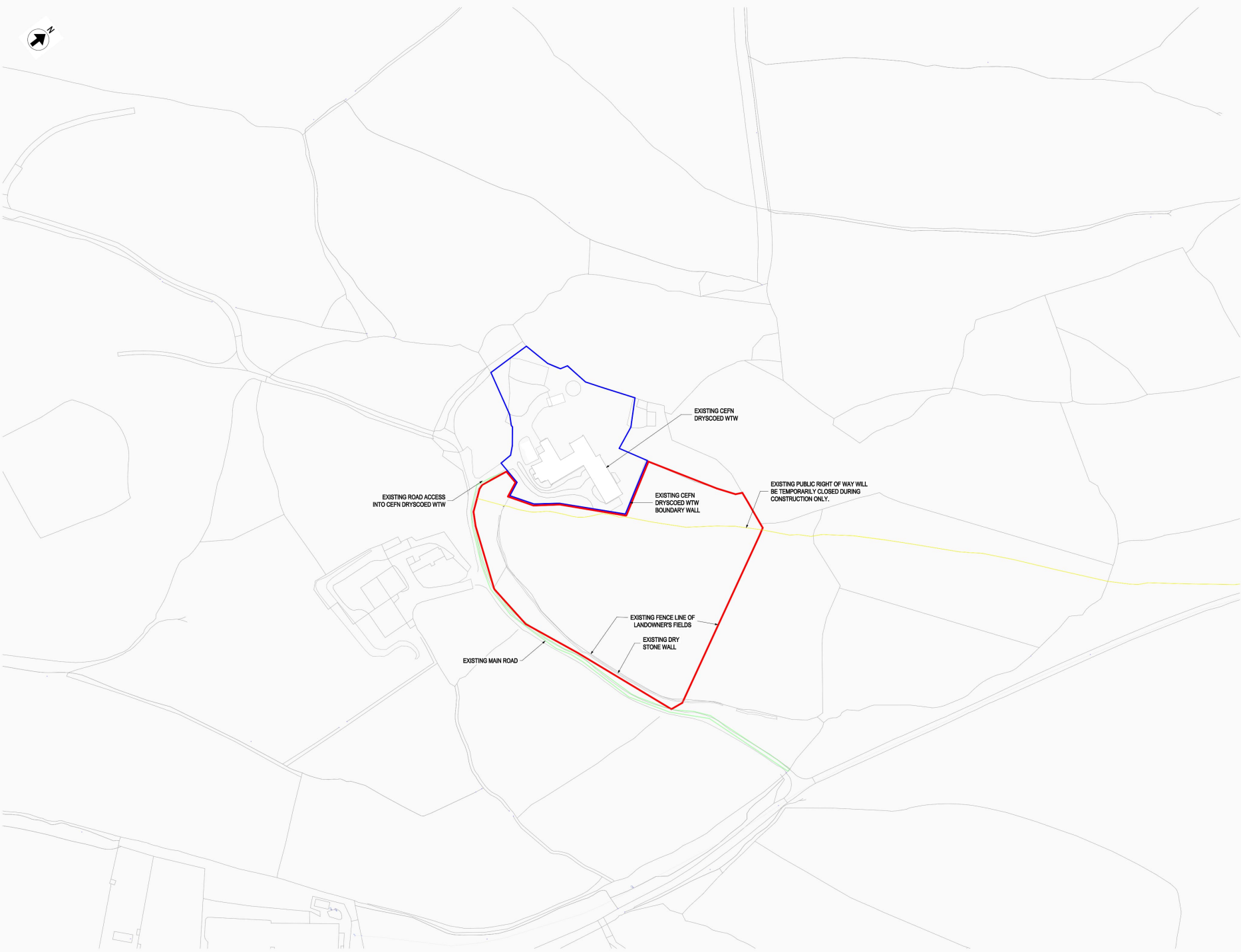

SITE BOUNDARY PLAN

1:1250

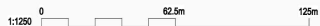

Dear Customer: Capital Delivery gives this information as to the position of its underground apparatus by way of general guidance only on the understanding that it is based on the best information available and no warranty as to its correctness is made. In the event of construction or other work which is likely to affect the position of the apparatus, the customer should refer to the appropriate drawings and any instructions issued by the relevant authority. It should be understood that the furnishing of this information is solely without prejudice to the provisions of the New Roads and Streetworks Act 2006 and the Company's right to be compensated for any damage to its apparatus.

Dear Customer: Capital Delivery can only identify public apparatus and the information as to the position of the private apparatus is given by way of general guidance only on the understanding that it is based on the best information available and no warranty as to its correctness is made. In the event of construction or other work which is likely to affect the position of the apparatus, the customer should refer to the appropriate drawings and any instructions issued by the relevant authority. It should be understood that the furnishing of this information is solely without prejudice to the provisions of the New Roads and Streetworks Act 2006 and the Company's right to be compensated for any damage to its apparatus.

Rev.	Date	By	Description	Chk.	App.	Iss. Date
P01	22.05.25	GS	FOR INFORMATION	GM	PRC	28.01.28



Project Name: CEFN DRYSCOED DAF

Drawing Title: SITE BOUNDARY PLAN

Subsidiary Code: S2

FOR INFORMATION

Technician: GS	Originator: LC	Date: 22.05.25
----------------	----------------	----------------

Internal Project Number: D20241800A	Scale: As Indicated @	Rev: P01
-------------------------------------	-----------------------	----------

Drawing Number: B17545-123532-14-XX-DR-CA-PN1205	MMB
--	-----